

SANI-LAV[®] COLUMBIA PRODUCTS

Large-Sized Industrial Nozzle with Stainless Steel Body Model N8S20 Series



Model N8S20



Model N8SB20



Model N8SW20



Model N8SR20



Also available with brass main body.
Model N8S20

All Models include N20 Swivel
3/4" GHT, 3/4" hose barb

N8S20 Series Universal Features

- Heavy-duty stainless steel body with tainless steel components
- Insulated rubber cover with yellow arrow directions
- Safety shut off trigger when released
- 3/4" GHT inlet allows direct hose connection
- Swivel Adapter N20 (Included)
- Replacement parts available
- Maximum operating temperature: 200°F/93°C
- Maximum working pressure 150 psi
- Weight 2.3 lb.
- Dimensions: L 5.04" x H 5.24" x W 1.71"

Models

Color	Standard
Safety Orange	N8S20
Black	N8SB20
White	N8SW20
Red	N8SR20

Quick Specs

Max Temperature	200°F/93°C
Max Pressure	150 psi
Inlet	3/4" Female GHT
Tip	Not Threaded
Body Material	Stainless Steel
Handle Type	Stainless Steel
Weight	2.3 lbs.
Hose Adapter	Models N20 (Included)
Dimensions	L 5.04" x H 5.24" x W 1.71"

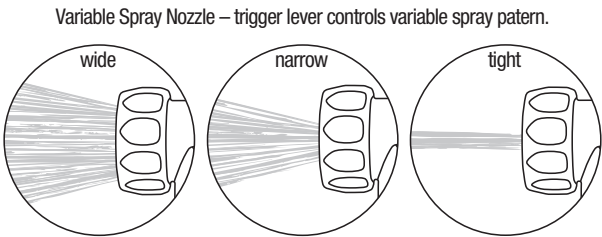

**WARNING:** This product can expose you to chemicals including Lead, and Phthalates (DEHP) which are known to the State of California to cause cancer and birth defects or other reproductive harm. For more information go to www.P65Warnings.ca.gov.

N8S20 Replacement Parts

Description	Part Number
Orange Insolated Cover	A N8OC
Black Insolated Cover	B N8BC
White Insolated Cover	C N8WC
Red Insolated Cover	D N8RC
Stainless Steel Main Body	E N8SSMB
Handle Replacement Kit	F N8HR
Barrel Cartridge Replacement Kit	G N8BRS
Bolt Sleeve	I N8ES
Locking Nut	J N8FS

Replacement Covers



A Replacement Cover



E Body



I Bolt Sleeve



J Locking Nut



F Handle Replacement Kit
Stainless steel handle
Stainless steel nut
Nylon bushing
Stainless steel bolt

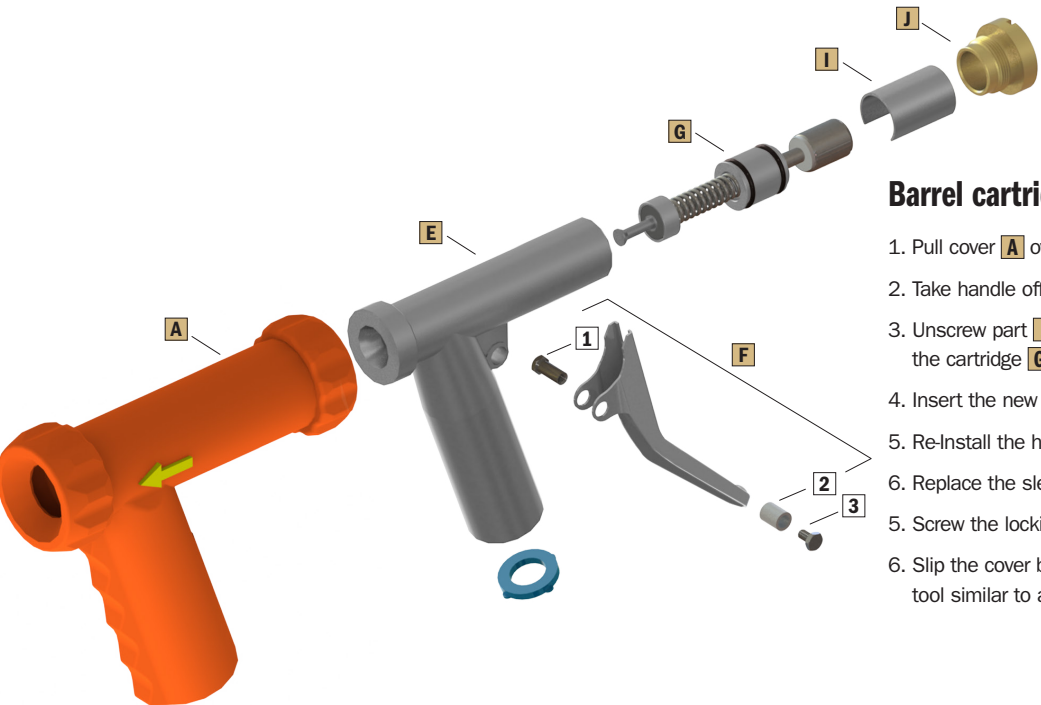

Barrel cartridge replacement kit Instructions

1. Pull cover **A** over the back of nozzle to expose the back end.
2. Take handle off nozzle by removing parts **1**, **2**, and **3**.
3. Unscrew part **J** locking nut and remove bolt sleeve **I** and the cartridge **G** or **H**.
4. Insert the new cartridge.
5. Re-Install the handle.
6. Replace the sleeve with the open end facing down.
5. Screw the locking nut back into place.
6. Slip the cover back over the nozzle end using a round ended tool similar to a shoe horn.