

SANI-LAV[®] COLUMBIA PRODUCTS

Large-Sized Industrial Nozzles with Brass Body Model N820 Series



Model N820
Model N8120



Model N8B20
Model N81B20



Model N8W20
Model N81W20



Model N8R20
Model N81R20



All Models include N20 Swivel
3/4" GHT, 3/4" hose barb

Also available with stainless steel main body.
Model N8S20



N820 Series Universal Features

- Heavy-duty brass body with brass and stainless steel components
- Insulated rubber cover with yellow arrow directions
- Safety shut off trigger when released
- 3/4" GHT inlet allows direct hose connection
- Swivel Adapter N17 and N20 (Sold Separately)
- Replacement parts available
- Maximum operating temperature: 200°F/93°C
- Maximum working pressure 150 psi
- Weight 2.3 lb.
- Dimensions: L 5.04" x H 5.24" x W 1.71"

Models

Color	Standard	Low-Flow
Safety Orange	N820	N8120
Black	N8B20	N81B20
White	N8W20	N81W20
Red	N8R20	N81R20

Quick Specs

Max Temperature	200°F/93°C
Max Pressure	150 psi
Inlet	3/4" Female GHT
Tip	Not Threaded
Body Material	Brass
Handle Type	Stainless Steel
Weight	2.3 lbs.
Hose Adapter	Model N20 (Included)
Dimensions	L 5.04" x H 5.24" x W 1.71"



Variable Spray Nozzle – trigger lever controls variable spray pattern.

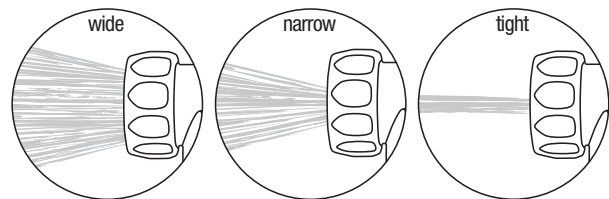

Water Flow Rate Comparison

PSI	Standard GPM	Low-Flow GPM	Water Saving
30	3.7	2.2	40.52%
40	4.2	2.4	42.50%
50	4.7	2.7	41.94%
60	5.4	3.0	44.44%
70	6.3	3.8	39.20%
80	6.8	4.2	38.24%
90	7.2	4.5	37.50%
100	7.9	4.8	39.24%

Notice for California Consumers

WARNING: This product can expose you to chemicals including Lead, and Phthalates (DEHP) which are known to the State of California to cause cancer and birth defects or other reproductive harm. For more information go to www.P65Warnings.ca.gov.

N820 Replacement Parts

Description	Part Number
Orange Insolated Cover	A N80C
Black Insolated Cover	B N8BC
White Insolated Cover	C N8WC
Red Insolated Cover	D N8RC
Brass Main Body	E N8MB
Handle Replacement Kit	F N8HR
Barrel Cartridge Replacement Kit	G N8BR
Barrel Cartridge Replacement Kit	H N8BR1
Bolt Sleeve	I N8E
Locking Nut	J N8F

Replacement Covers

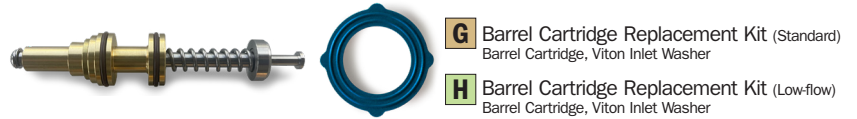

A Replacement Cover



E Body

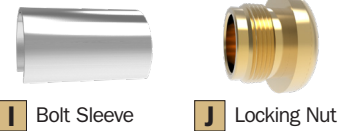

I Bolt Sleeve

J Locking Nut



F Handle Replacement Kit
Stainless steel handle
Stainless steel nut
Nylon bushing
Stainless steel bolt

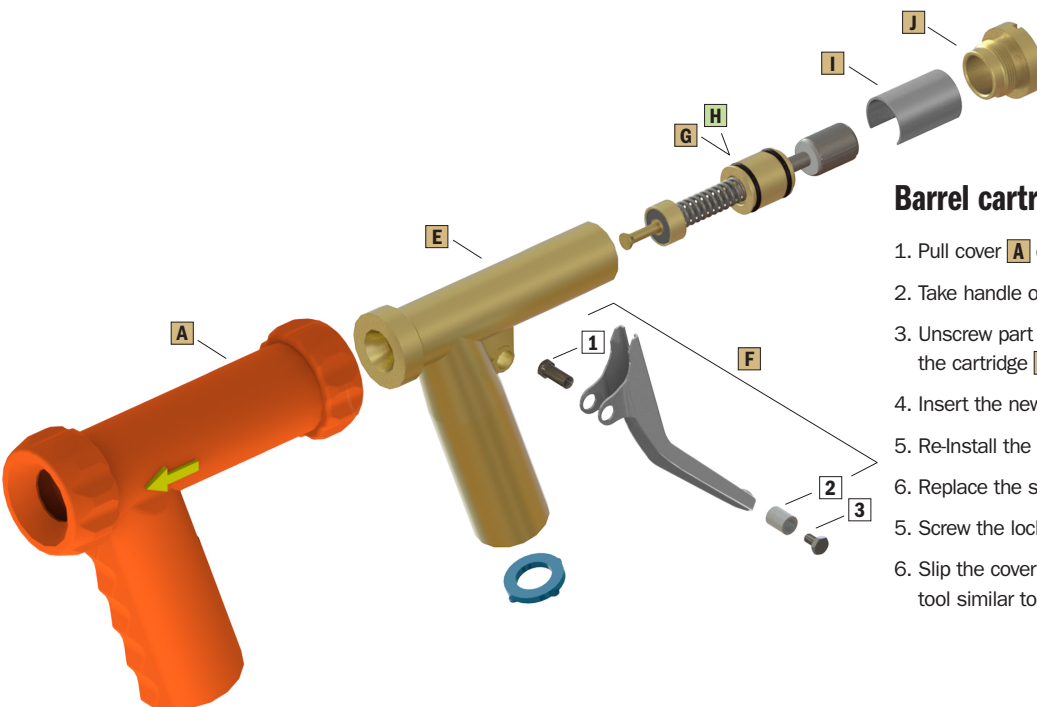

Barrel cartridge replacement kit Instructions

1. Pull cover **A** over the back of nozzle to expose the back end.
2. Take handle off nozzle by removing parts **1**, **2**, and **3**.
3. Unscrew part **J** locking nut and remove bolt sleeve **I** and the cartridge **G** or **H**.
4. Insert the new cartridge.
5. Re-Install the handle.
6. Replace the sleeve with the open end facing down.
5. Screw the locking nut back into place.
6. Slip the cover back over the nozzle end using a round ended tool similar to a shoe horn.