

# SANI-LAV<sup>®</sup> COLUMBIA PRODUCTS

## Large-Sized Industrial Nozzles with Brass Body Model N8 Series

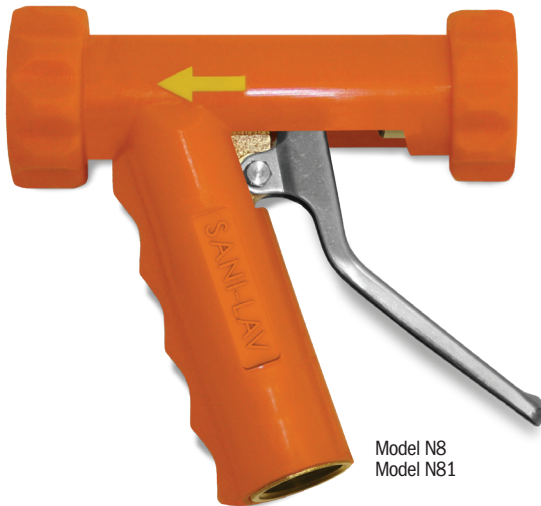

Model N8  
Model N81

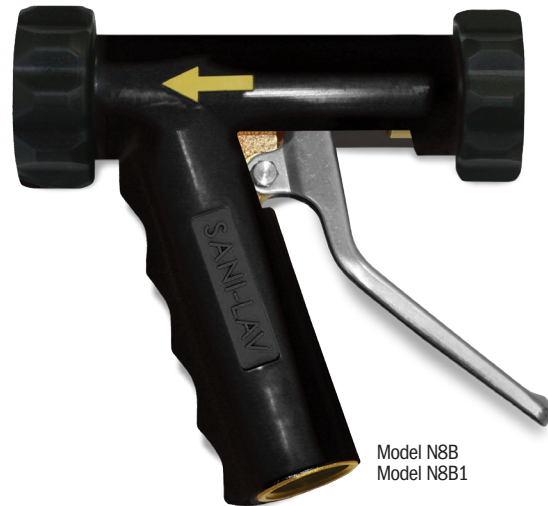

Model N8B  
Model N8B1



Model N8W  
Model N8W1

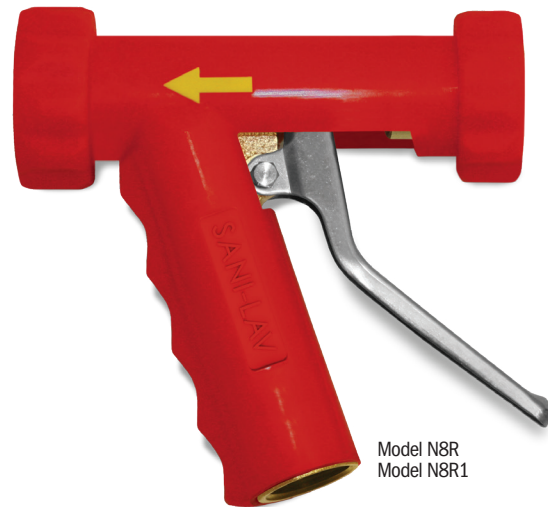

Model N8R  
Model N8R1

Also available with stainless steel main body.  
Model N8S20

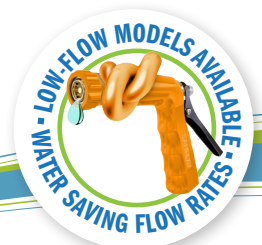

### N8 Series Universal Features

- Heavy-duty brass body with brass and stainless steel components
- Insulated rubber cover with yellow arrow directions
- Safety shut off trigger when released
- 3/4" GHT inlet allows direct hose connection
- Swivel Adapter N17 and N20 (Sold Separately)
- Replacement parts available
- Maximum operating temperature: 200°F/93°C
- Maximum working pressure 150 psi
- Weight 2.3 lb.
- Dimensions: L 5.04" x H 5.24" x W 1.71"

### Models

| Color         | Standard | Low-Flow |
|---------------|----------|----------|
| Safety Orange | N8       | N81      |
| Black         | N8B      | N8B1     |
| White         | N8W      | N8W1     |
| Red           | N8R      | N8R1     |

### Quick Specs

|                 |                                      |
|-----------------|--------------------------------------|
| Max Temperature | 200°F/93°C                           |
| Max Pressure    | 150 psi                              |
| Inlet           | 3/4" Female GHT                      |
| Tip             | Not Threaded                         |
| Body Material   | Brass                                |
| Handle Type     | Stainless Steel                      |
| Weight          | 2.3 lbs.                             |
| Hose Adapter    | Models N17 and N20 (Sold Separately) |
| Dimensions      | L 5.04" x H 5.24" x W 1.71"          |

### Water Flow Rate Comparison

| PSI | Standard GPM | Low-Flow GPM | Water Saving |
|-----|--------------|--------------|--------------|
| 30  | 3.7          | 2.2          | 40.52%       |
| 40  | 4.2          | 2.4          | 42.50%       |
| 50  | 4.7          | 2.7          | 41.94%       |
| 60  | 5.4          | 3.0          | 44.44%       |
| 70  | 6.3          | 3.8          | 39.20%       |
| 80  | 6.8          | 4.2          | 38.24%       |
| 90  | 7.2          | 4.5          | 37.50%       |
| 100 | 7.9          | 4.8          | 39.24%       |



.75" GHT Female

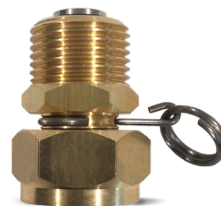

N17 Swivel Hose Adapter (sold separately)



N20 Swivel Hose Adapter (sold separately)

Variable Spray Nozzle

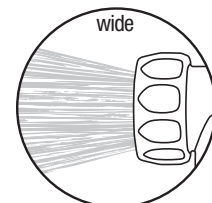

wide

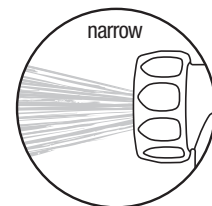

narrow

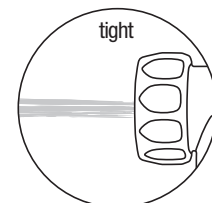

tight

Trigger lever controls variable spray pattern

**Notice for California Consumers**  
**WARNING:** This product can expose you to chemicals including Lead, and Phthalates (DEHP) which are known to the State of California to cause cancer and birth defects or other reproductive harm. For more information go to [www.P65Warnings.ca.gov](http://www.P65Warnings.ca.gov).

### N8 Replacement Parts

| Description                      | Part Number    |
|----------------------------------|----------------|
| Orange Insolated Cover           | <b>A</b> N8OC  |
| Black Insolated Cover            | <b>B</b> N8BC  |
| White Insolated Cover            | <b>C</b> N8WC  |
| Red Insolated Cover              | <b>D</b> N8RC  |
| Brass Main Body                  | <b>E</b> N8MB  |
| Handle Replacement Kit           | <b>F</b> N8HR  |
| Barrel Cartridge Replacement Kit | <b>G</b> N8BR  |
| Barrel Cartridge Replacement Kit | <b>H</b> N8BR1 |
| Bolt Sleeve                      | <b>I</b> N8E   |
| Locking Nut                      | <b>J</b> N8F   |

Replacement Covers



**A** Replacement Cover



**E** Body

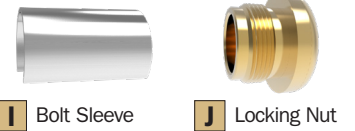

**I** Bolt Sleeve

**J** Locking Nut



**F** Handle Replacement Kit  
Stainless steel handle  
Stainless steel nut  
Nylon bushing  
Stainless steel bolt

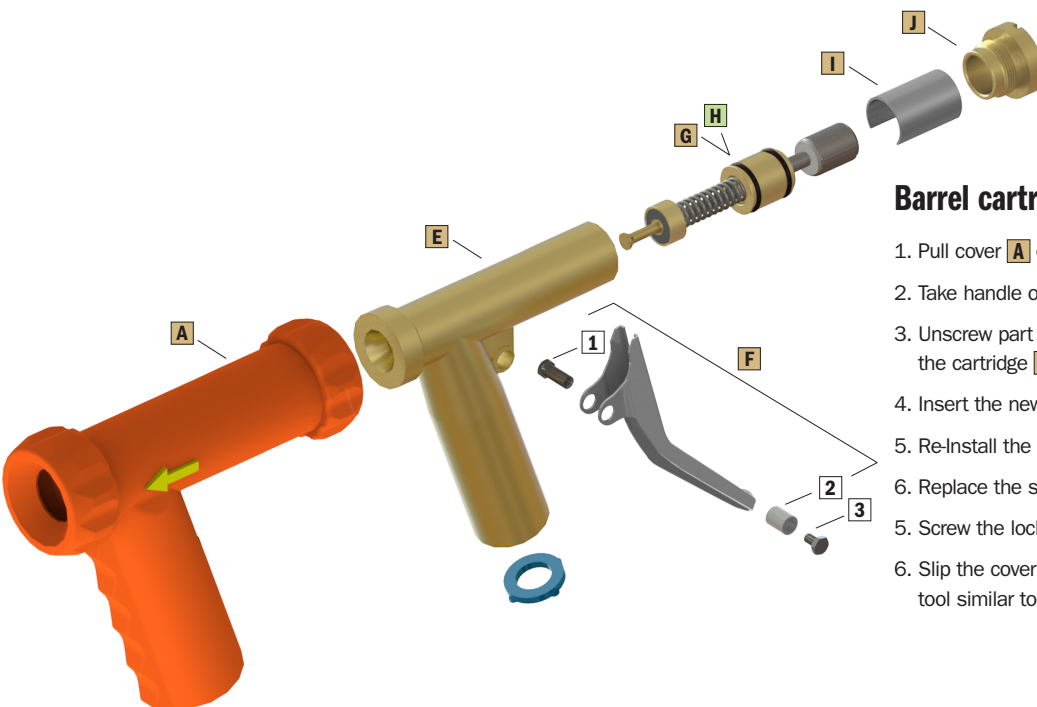

### Barrel cartridge replacement kit Instructions

1. Pull cover **A** over the back of nozzle to expose the back end.
2. Take handle off nozzle by removing parts **1**, **2**, and **3**.
3. Unscrew part **J** locking nut and remove bolt sleeve **I** and the cartridge **G** or **H**.
4. Insert the new cartridge.
5. Re-Install the handle.
6. Replace the sleeve with the open end facing down.
5. Screw the locking nut back into place.
6. Slip the cover back over the nozzle end using a round ended tool similar to a shoe horn.