

# SANI-LAV<sup>®</sup> COLUMBIA PRODUCTS

## Mid-Sized Industrial Nozzles with Stainless Steel Body Model N1SS Series



Model N1SS

Model N1SSB

Model N1SSW



Model N1SSR

Model N1SSY

Also available with aluminum and brass main bodies.  
Models N1A and N1

### N1SS Series Universal Features

Model	Color	Inlet	Material	Max PSI	Max Temp.	GPM @ 100 PSI	Weight	Includes
N1SS	Safety Orange	3/4" GHT	Stainless Steel, EPDM Cover	150	200°F/93°C	4.9	1.0 lbs.	—
N1SSB	Black	3/4" GHT	Stainless Steel, EPDM Cover	150	200°F/93°C	4.9	1.0 lbs.	—
N1SSW	White	3/4" GHT	Stainless Steel, EPDM Cover	150	200°F/93°C	4.9	1.0 lbs.	—
N1SSY	Yellow	3/4" GHT	Stainless Steel, EPDM Cover	150	200°F/93°C	4.9	1.0 lbs.	—
N1SSR	Red	3/4" GHT	Stainless Steel, EPDM Cover	150	200°F/93°C	4.9	1.0 lbs.	—

### Quick Specs

Max Temperature	200°F/93°C
Max Pressure	150 psi
Inlet	3/4" Female GHT allows direct hose connection
Tip	Not Threaded
Body Material	Stainless steel
Components	Stainless steel
Cover Material	Insulated rubber with yellow arrow directions
Handle Type	Stainless steel
Trigger	Safety shut off when released
Hose Adapter	Model N17S (Sold Separately)
Weight	1.0 lbs.
Dimensions	L 5.22" x H 5.24" x W 1.81"

### Water Flow Rates

PSI	Standard GPM
20	2.0
30	2.6
40	3.0
50	3.3
60	3.7
70	3.9
80	4.3
90	4.7
100	4.9
110	5.1
120	5.4
130	5.6
140	5.9
150	6.2



Variable Spray Nozzle – trigger lever controls variable spray pattern.

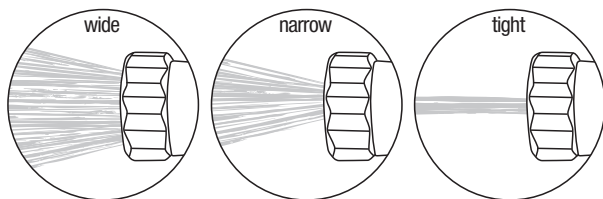

### N1SS Replacement Parts

Description	Part Number
Orange Insolated Cover	<b>A</b> N10C
Black Insolated Cover	<b>B</b> N1BC
White Insolated Cover	<b>C</b> N1WC
Red Insolated Cover	<b>D</b> N1RC
Yellow Insolated Cover	<b>E</b> N1YC
Stainless Steel Main Body	<b>F</b> N1SSMB
Handle Replacement Kit	<b>G</b> N1HR
Barrel Cartridge Replacement Kit	<b>H</b> N1BRS
Bolt Sleeve	<b>I</b> N1E
Locking Nut	<b>J</b> N1F

Replacement Covers

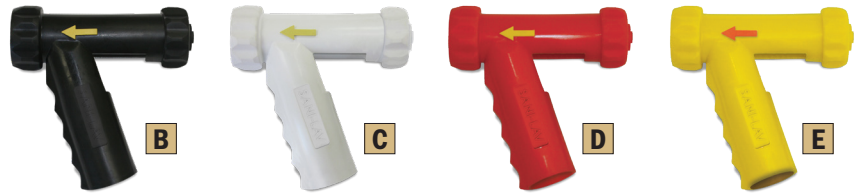

**A** Replacement Cover



**F** Body

**G** Handle Replacement Kit  
Stainless steel handle  
Stainless steel nut  
Nylon bushing  
Stainless steel bolt

**I** Bolt Sleeve

**J** Locking Nut

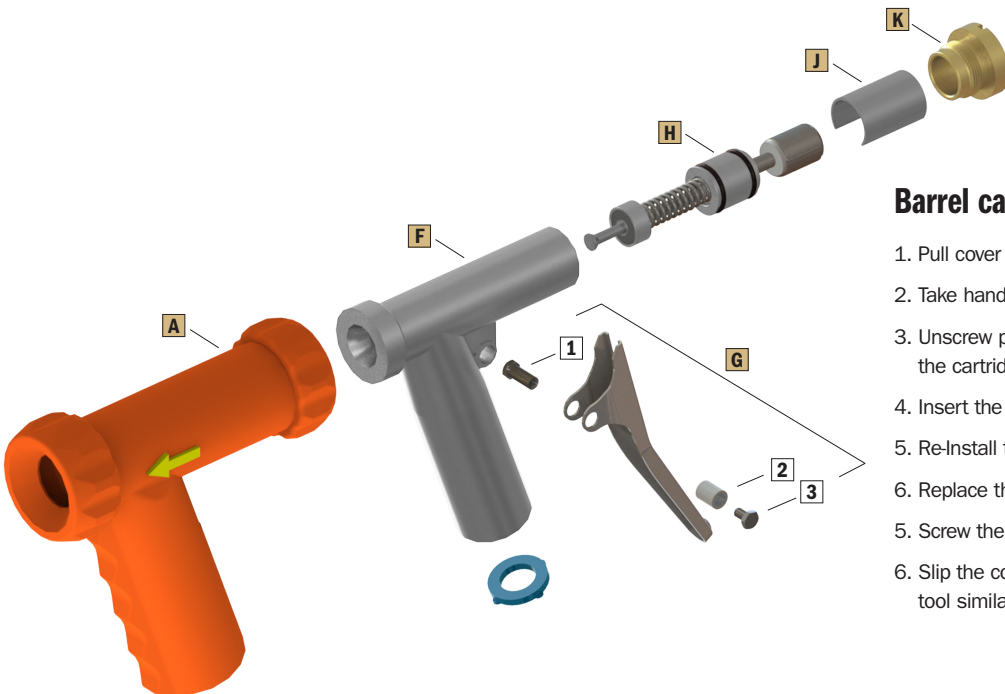

### Barrel cartridge replacement kit Instructions

1. Pull cover **A** over the back of nozzle to expose the back end.
2. Take handle off nozzle by removing parts **1**, **2**, and **3**.
3. Unscrew part **J** locking nut and remove bolt sleeve **I** and the cartridge **H**.
4. Insert the new cartridge.
5. Re-Install the handle.
6. Replace the sleeve with the open end facing down.
5. Screw the locking nut back into place.
6. Slip the cover back over the nozzle end using a round ended tool similar to a shoe horn.