

SANI-LAV[®] COLUMBIA PRODUCTS

Operating Manual for 4-Person Hands-Free Wall Mount Stainless Steel Wash Station

Models 58W1 and 58W1-0.5

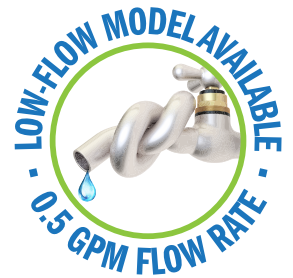
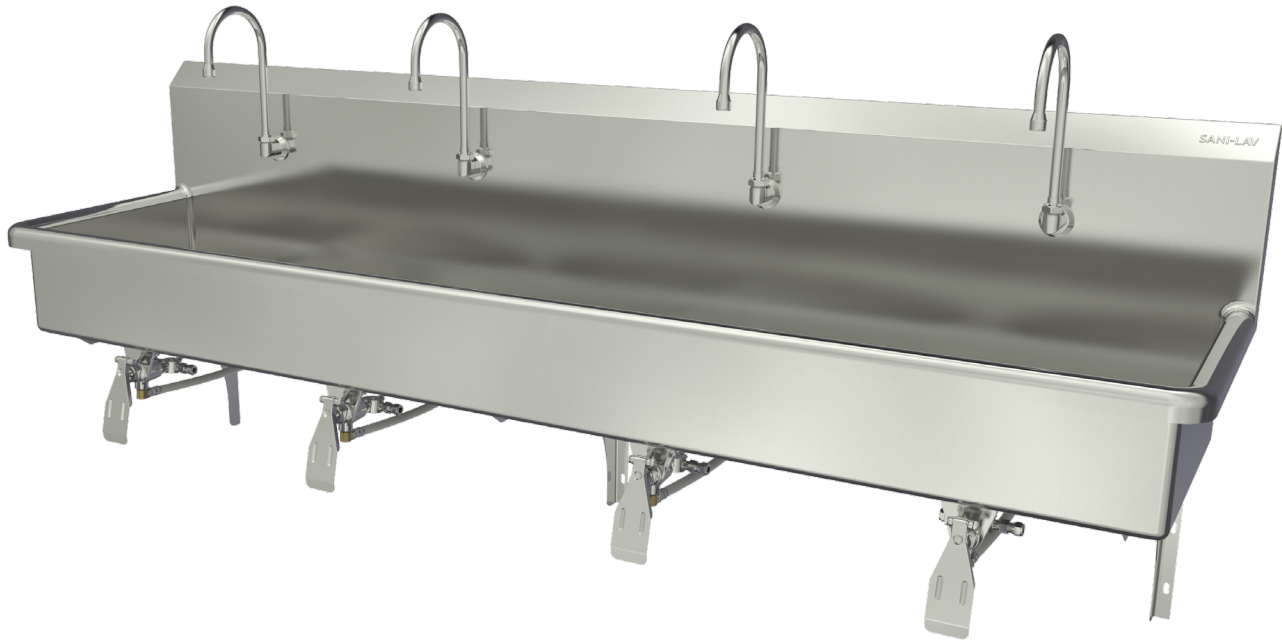

Columbia does not recommend use with harsh chemicals.

Product Compliance

NSF/ANSI 2 Food Equipment, NSF/ANSI 372 Low-Lead



Parts List

- ☐ (1) Wall mount wash station
- ☐ (4) Single knee pedal valve
- ☐ (8) Valve mounting nuts
- ☐ (4) Swivel gooseneck spout with aerator
- ☐ (4) Connecting tube for valve to spout connection
- ☐ (8) Fittings, brass, 0.375" male compression and 0.375" male NPT
- ☐ (4) Mixing check valve
- ☐ (3) Wall-mounting brackets
- ☐ (3) Support brackets
- ☐ (6) Nuts and washers for mounting sink to support brackets
- ☐ (2) Strainer assembly with basket

Tools Required

- ☐ Tape measure
- ☐ Adjustable wrench
- ☐ Drill motor and drill bits
- ☐ Pipe wrench
- ☐ Level
- ☐ Safety glasses
- ☐ Screw drivers: phillips and standard
- ☐ Pencil
- ☐ Socket wrench

Installation Instructions

Step 1

1. Establish Sink location on the wall.
2. Measure a recommended 45" from finished floor and draw a level line which will be the top edge of the wall mounting bracket.
3. Hold the wall mounting bracket against the wall and mark the wall where the holes are. Drill holes and secure bracket to the wall as shown in illustration A. Screws are not provided.

Step 2

1. Install spout assemblies to the sink.
2. Install elbow fitting (provided) to the spout assemblies.
3. Connect supply lines (provided) to the spout assemblies.
4. Install strainer assembly.

Step 3

1. Position Sink onto the wall bracket.
2. Mount Support Bracket to the bottom of the sink. Do not tighten.
3. Slide or push support brackets against the wall and mark holes for fastening. See illustration B.
4. Remove Support Brackets from the sink and drill holes for fastening.
5. Install fastening hardware to the drilled holes. (not included)
6. Mount support bracket to the bottom of the sink and fasten them to the wall.

Step 4

1. Install Knee Pedal valves onto the sink.
2. Install elbow fittings to the Knee Pedal valves.
3. Connect the connecting tubes from the Spouts to the Knee Pedal Valves.

Step 5

1. Connect waste line or drain pipe to the strainer assembly.
2. Connect Hot and Cold water supply line to the water source.

Step 6

1. Remove aerator from the spout assembly and flush water system. Check connections for leaks. Replace aerator onto the spout assembly.
2. We recommend sealing top of backsplash to wall as shown in illustration C.

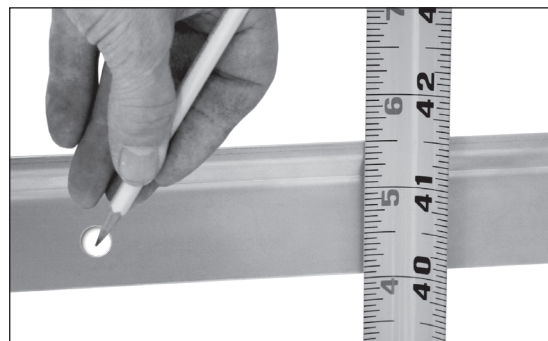

Illustration A



Illustration B



Illustration C

Go to columbiasinks.com for more information on replacement parts and installation videos.

Notice for California Consumers

WARNING: This product can expose you to chemicals including Chromium (hexavalent compounds), Lead, and Phthalates (DEHP) which are known to the State of California to cause cancer and birth defects or other reproductive harm. For more information go to www.P65Warnings.ca.gov.

NOTE: Lead content originates from Brass components in valves and faucets and is certified under NSF/ANSI 372 as containing less than 0.25% lead in wetted surfaces.

COLUMBIA PRODUCTS
800.626.2117 • columbiasinks.com • info@columbiasinks.com

Trouble Shooting Guide

| Problem | Possible Cause | To Diagnose | Remedy |
|--|--|--|---|
| Water drips from spout or valve stem assembly. | Flat washer on the stem/plunger is worn. | To determine if the leak source is from the hot or cold side shut cold water source off. See if water still leaks from the spout. If leak continues then repair hot side if not repair cold side | We recommend installing valve repair kit. |
| Water leaks from the front of the valve. | O-Rings on the plunger are worn out. | Visually determine whether the cold or hot side is leaking. | We recommend replacing threaded insert, plunger assembly & spring. See illustrations below. |

Valve Repair Instructions

Note: Valves are designed to be repaired without having to be disconnected from mount or plumbing.

1. Turn off water source. Do not remove valve from sink.
2. Remove pedal assembly using a 15/16" open end wrench or socket wrench. As shown in illustration A.
3. Using a 1" deep socket wrench or closed end wrench remove insert assembly as shown in illustration B.
4. Replace with new repair kit as shown on illustration C.
5. Reinstall pedal assembly and turn water source on.



Illustration A

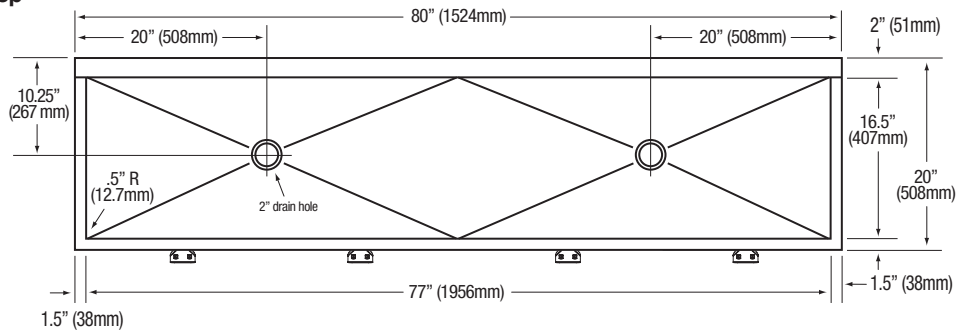

Illustration B

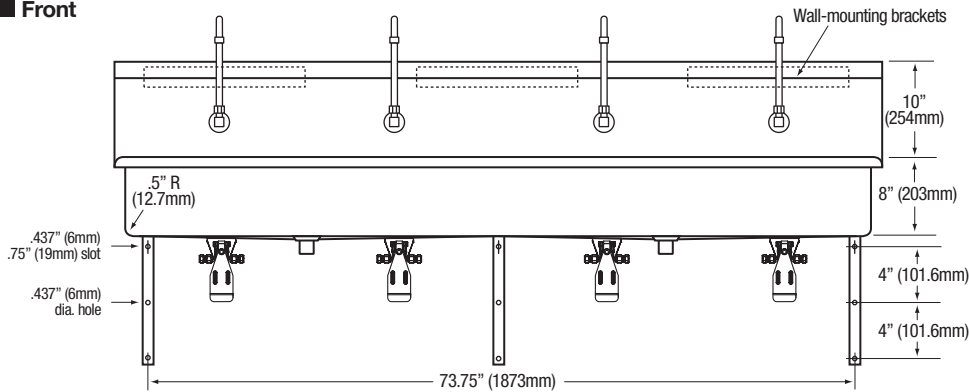

Illustration C

■ Top



■ Front



■ Side

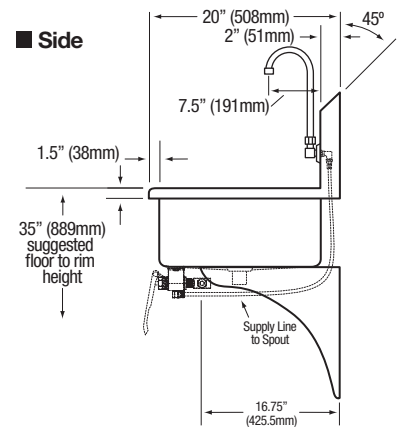

■ Hole Configurations

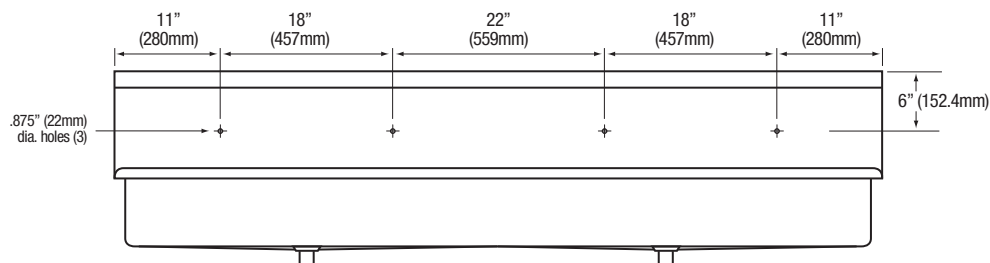

■ Wall Mounting Detail

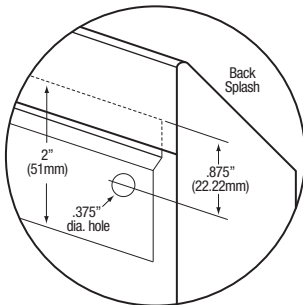

■ Supply Line Detail

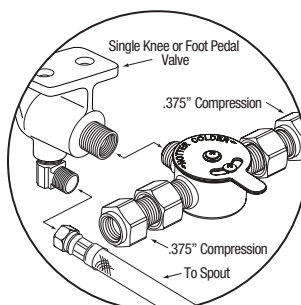
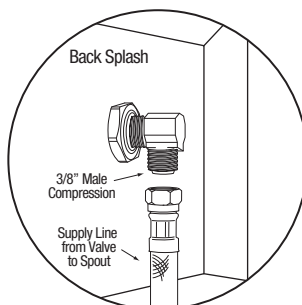

Replacement Parts

| Part No. | Description | Application |
|----------------|------------------------------------|-------------------------|
| A 1041 | Operated, Long Foot | 103/104/105/106 (S) (L) |
| B 1042 | Operated, Short Foot | 101/102 (S) (L) |
| C 1043 | Operated, Knee | 109/110/111/112 (S) (L) |
| D 1049 | Bolt & Nut Set (Stainless) | All Single Valves |
| E 1050 | Jam Nut (Stainless) | All Valves |
| F 1051 | Bolt & Nut Set (Stainless) | All Double Valves |
| G 1052 | Bracket | All Double Valves |
| H 1053 | Threaded Insert (Low Lead) | All Valves |
| I 1053S | Threaded Insert (Stainless) | All Valves |
| J 1054 | Bracket | All Single Valves |
| K 1055 | Plunger Assembly (Low Lead) | All Valves |
| L 1055S | Plunger Assembly (Stainless) | All Valves |
| M 1056 | Spring (Stainless) | All Valves |
| N 1057 | Body only, Double Valve (Low Lead) | All Double Valves |
| O 1058 | Body only, Single Valve | All Single Valves |
| P 1061L | Replacement Kit (Low Lead) | All Valves |
| Q 1061S | Replacement Kit (Stainless) | All Valves |

Double Knee or Foot Pedal

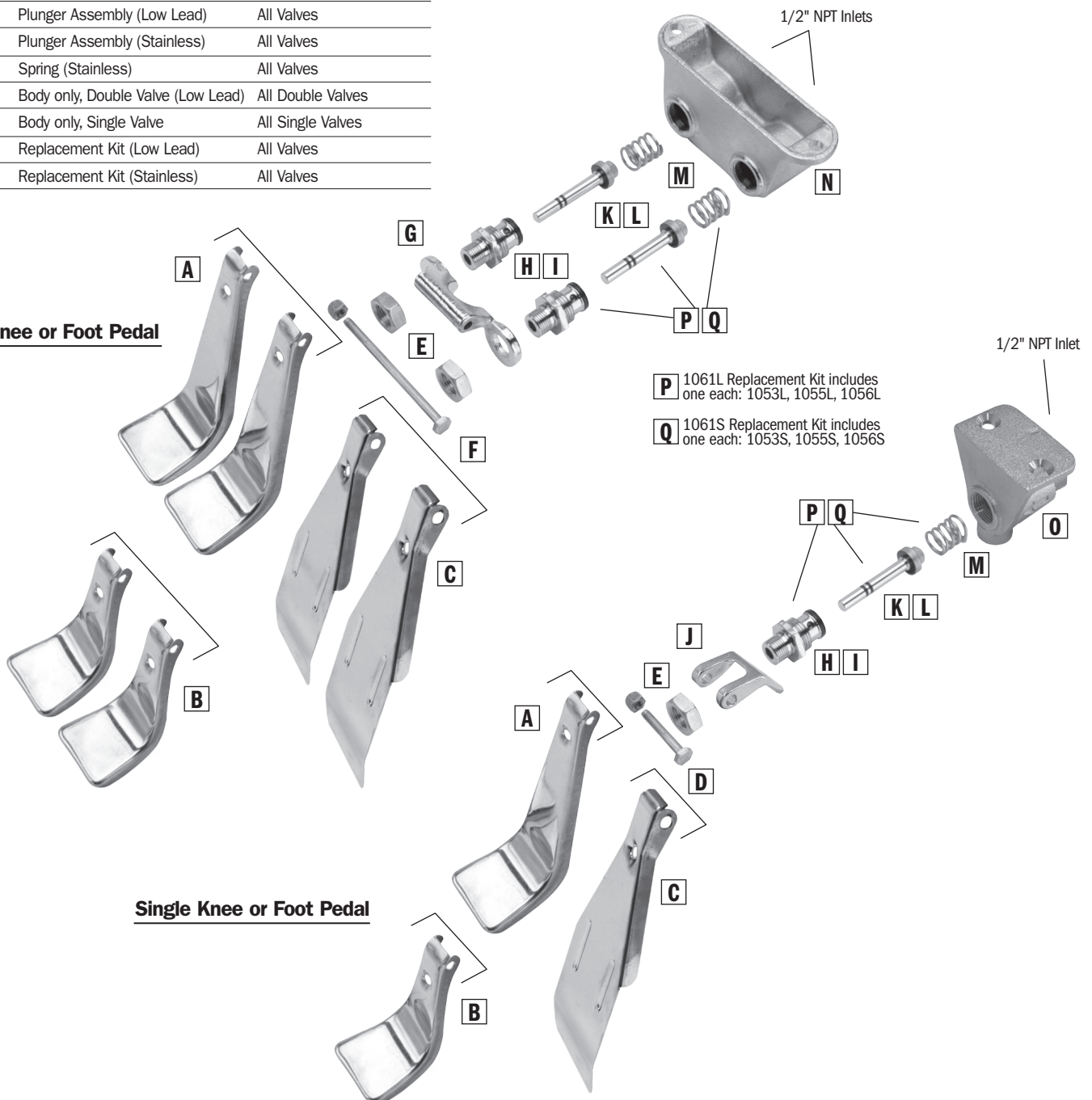

Single Knee or Foot Pedal

COLUMBIA PRODUCTS

800.626.2117 • columbiasinks.com • info@columbiasinks.com

Care and Maintenance

Regular cleaning will preserve the appearance and integrity of the surface. Stainless steel can easily be cleaned and kept stain-free using various methods.

Recommendations:

- Clean with an abrasive cleaner like, Bon-Ami or Zud weekly or bi-weekly. Always scrub in the direction of the grain or polish lines. Another option is to use Baking soda. Make sure to rinse well and dry. Illustration A
- Most soaps and detergents contain chlorides, we recommend rinsing the stainless-steel sink with hot water after use, to prevent corrosion. Illustration B
- Regularly dry your sink to prevent water and surface rust marks. Illustration C
- Do not leave salt in the sink or near a saltwater environment.
- Use a quality stainless steel cleaner and follow cleaner instructions. Wipe along the grain (NOT against). Illustration D

Things to Avoid:

- Avoid harsh abrasive cleaners and corrosive chemicals.
- Avoid abrasive scouring pads, carbon steel brushes and steel wool for cleaning as iron particles left behind can lead to rust.
- Avoid the use of oily rags or greasy cloths when wiping the surface. To avoid water spots, wipe dry after use.

Additional Tips:

- Regularly drying your sink works wonders to prevent water and surface rust marks.
- Wear rubber gloves when working with cleaners to protect your hands.
- Never mix cleaners. Some products react to create dangerous gases.
- There are thousands of blended or compound cleaners on the market. Users are advised to contact suppliers of solvents for information on their applications on stainless steel.
- DO NOT USE SOLVENTS in closed spaces or while smoking.
- Note: Columbia does not recommend use with harsh chemicals.



Illustration A



Illustration B



Illustration C

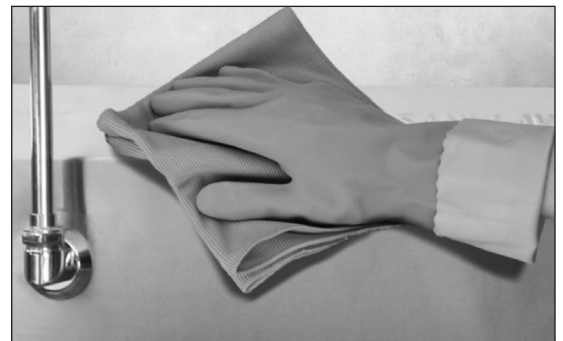

Illustration D