

SANI-LAV[®] COLUMBIA PRODUCTS

Large-Sized Industrial Nozzle with Brass Body Model N820

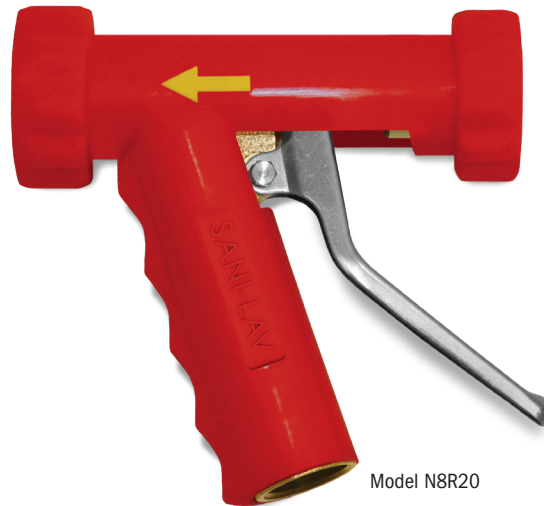

Model N820



Model N8R20



Model N8W20



Model N8B20



All Models include N20 Swivel
3/4" GHT, 3/4" hose barb

N820 Universal Features

- 3/4" GHT inlet allows direct hose connection
- Maximum working pressure 150 psi
- Maximum operating temperature: 200°F/93°C
- Weight 2.6 lbs.
- Safety shut off trigger when released
- Replaceable insulated safety orange, red, white or black covers

Model	Color	Body	Handle Type	Inlet	Max psi	Max Temp	Weight	GPM @ 100 psi	Swivel Adapter
Brass									
N820	Safety Orange	Brass	Stainless	3/4" FGHT	150	200	2.6	8.9	N20
N8R20	Red	Brass	Stainless	3/4" FGHT	150	200	2.6	8.9	N20
N8B20	Black	Brass	Stainless	3/4" FGHT	150	200	2.6	8.9	N20
N8W20	White	Brass	Stainless	3/4" FGHT	150	200	2.6	8.9	N20

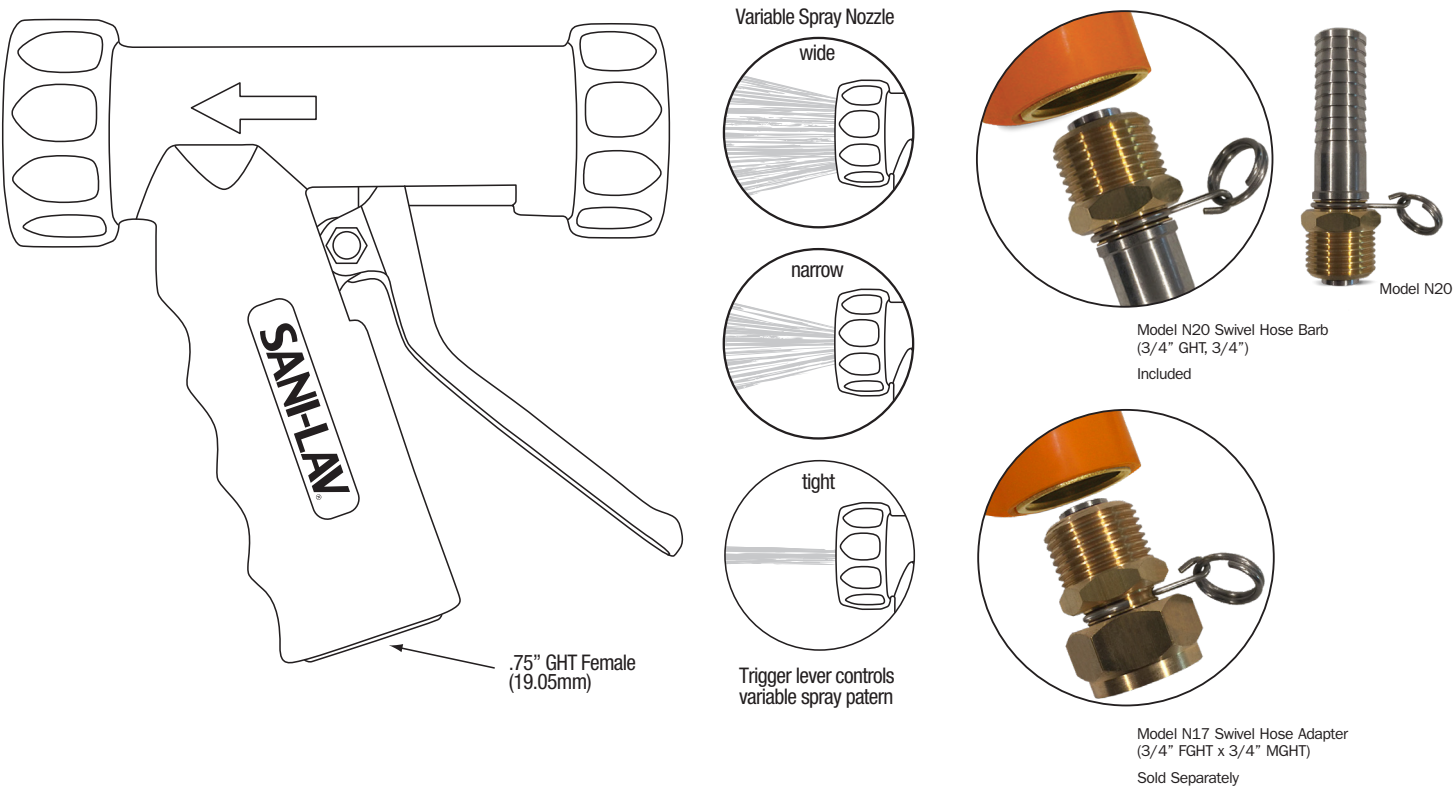

Water Flow Rate Comparison

PSI	Standard Model N8	Water Saver Model N81	Water Savings % Model N81
100	8.90 gpm	5.25 gpm	41.01%

Notice for California Consumers

WARNING: This product can expose you to chemicals including Lead, and Phthalates (DEHP) which are known to the State of California to cause cancer and birth defects or other reproductive harm. For more information go to www.P65Warnings.ca.gov.

N820 Replacement Parts

Part No. Description

A	N8OC	Orange insulated cover
B	N8RC	Red insulated cover
C	N8WC	White insulated cover
D	N8BC	Black insulated cover

E	N8MB	Main body
F	N8HR	Handle replacement kit
1		Stainless steel nut
2		Stainless steel handle
3		Stainless steel handle arm sleeve
4		Stainless steel handle bolt

G	N8BR	Barrel cartridge replacement kit
5		Flow adjustment tip
6		Washer
7		Washer sleeve
8		Axle
9		Stainless steel spring
10		O-ring
11		Axle bolt
12		O-ring
13		Nut
14		Lock washer
15		Bolt
16		Viton inlet washer
H	N8E	Bolt sleeve
I	N8F	Locking nut

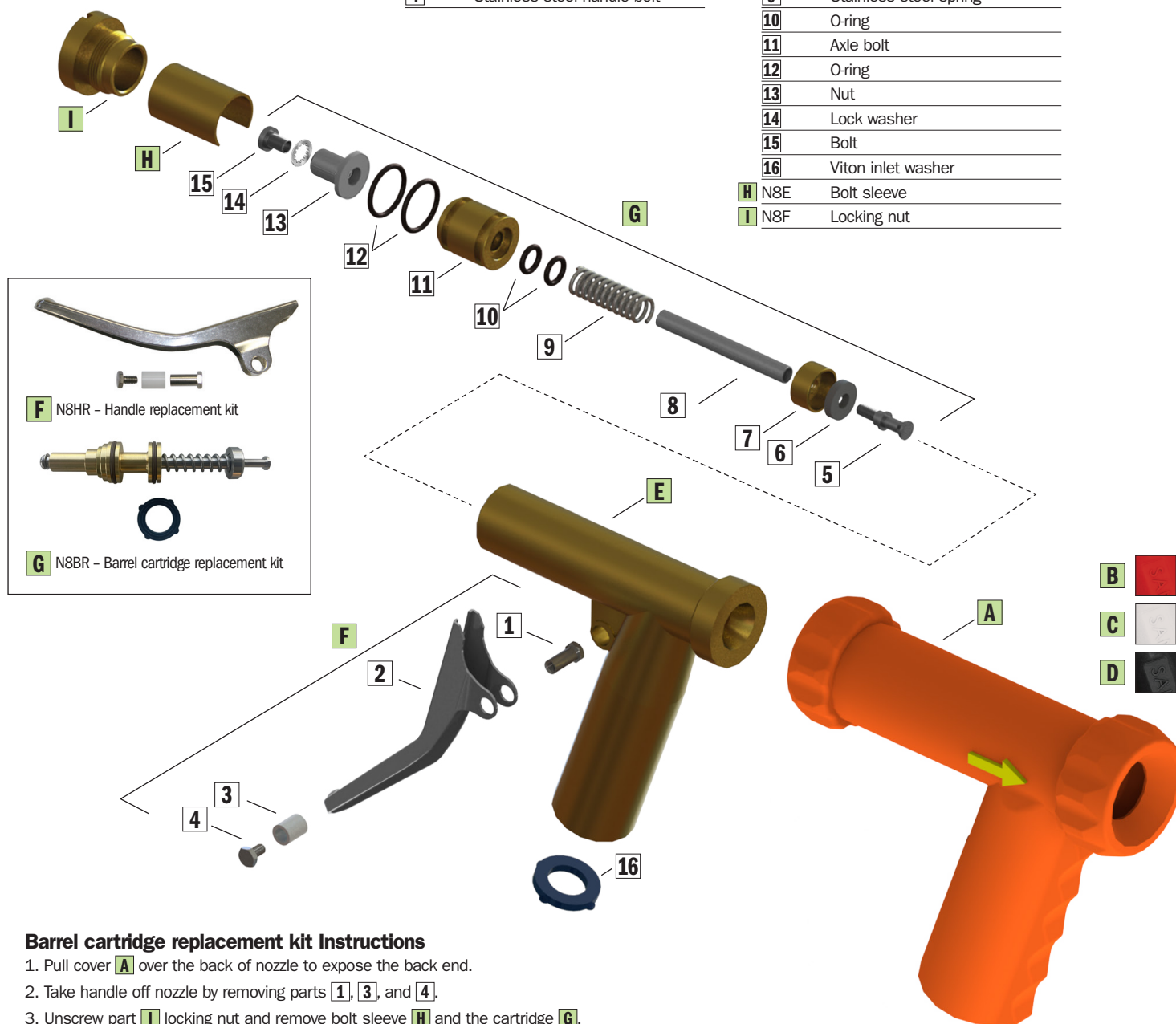

Barrel cartridge replacement kit Instructions

1. Pull cover **A** over the back of nozzle to expose the back end.
2. Take handle off nozzle by removing parts **1**, **3**, and **4**.
3. Unscrew part **I** locking nut and remove bolt sleeve **H** and the cartridge **G**.
4. Insert the new cartridge.
5. Re-Install the handle.
6. Replace the sleeve with the open end facing down.
5. Screw the locking nut back into place.
6. Slip the cover back over the nozzle end using a round ended tool similar to a shoe horn.