

SANI-LAV[®] COLUMBIA PRODUCTS

Mid-Sized Industrial Nozzles with Stainless Steel Body Model N1SS Series



Model N1SS



Model N1SSB



Model N1SSW



Model N1SSR



Model N1SSY

Also available with aluminum and brass main bodies.
Models N1A and N1

N1SS Series Universal Features

- Heavy-duty stainless steel body and brass and stainless-steel components
- Insulated rubber cover with yellow arrow directions
- Safety shut off trigger when released
- 3/4" GHT inlet allows direct hose connection
- Swivel Adapter N17S (sold separately)
- Replacement parts available
- Maximum operating temperature: 200°F/93°C
- Maximum working pressure 150 psi
- Weight 1.0 lb.
- Dimensions: L 5.22" x H 5.24" x W 1.81"

Models

Color	Standard
Safety Orange	N1SS
Black	N1SSB
White	N1SSW
Red	N1SSR
Yellow	N1SSY

Quick Specs

Max Temperature	200°F/93°C
Max Pressure	150 psi
Inlet	3/4" Female GHT
Tip	Not Threaded
Body Material	Stainless Steel
Handle Type	Stainless Steel
Weight	1.0 lb.
Hose Adapter	Model N17S (Sold Separately)
Dimensions	L 5.22" x H 5.24" x W 1.81"

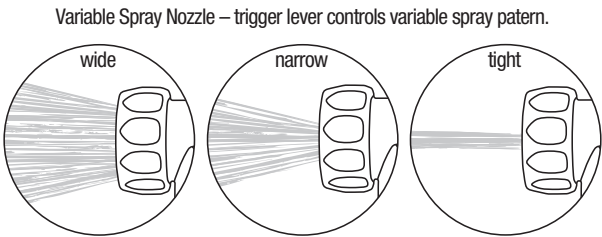

**WARNING:** This product can expose you to chemicals including Lead, and Phthalates (DEHP) which are known to the State of California to cause cancer and birth defects or other reproductive harm. For more information go to www.P65Warnings.ca.gov.

N1SS Replacement Parts

Description	Part Number
Orange Insolated Cover	A N10C
Black Insolated Cover	B N1BC
White Insolated Cover	C N1WC
Red Insolated Cover	D N1RC
Yellow Insolated Cover	E N1YC
Stainless Steel Main Body	F N1SSMB
Handle Replacement Kit	G N1HR
Barrel Cartridge Replacement Kit	H N1BRS
Bolt Sleeve	I N1E
Locking Nut	J N1F



A Replacement Cover

Replacement Covers

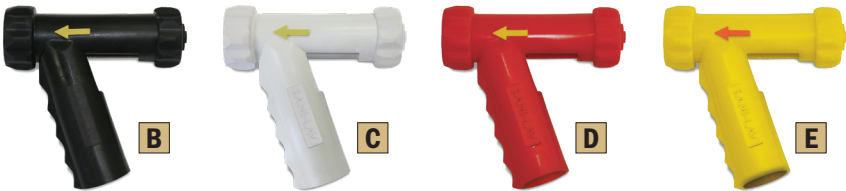

B

C

D

E



H Barrel Cartridge Replacement Kit (Standard)
Barrel Cartridge, Viton Inlet Washer

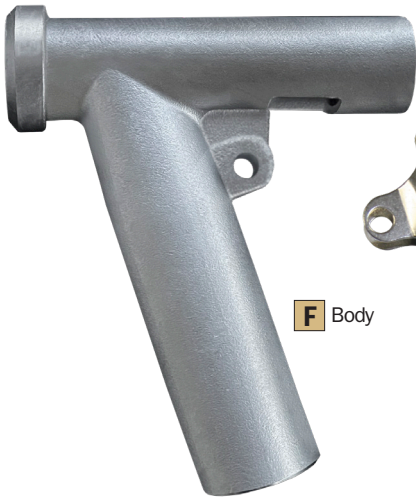

F Body



I Bolt Sleeve



J Locking Nut



G Handle Replacement Kit
Stainless steel handle
Stainless steel nut
Nylon bushing
Stainless steel bolt

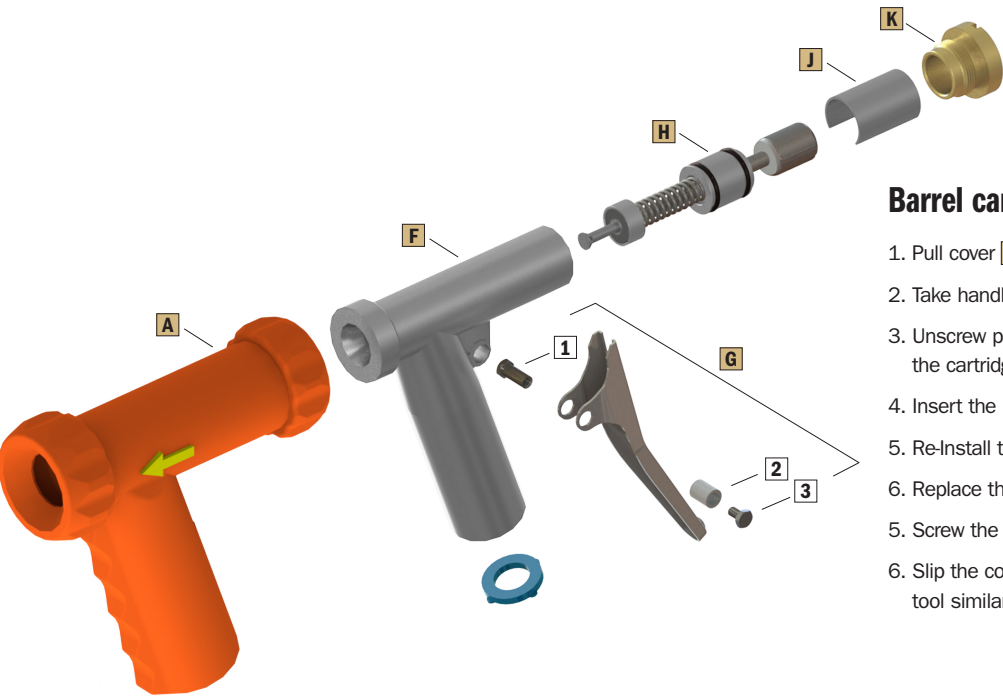

Barrel cartridge replacement kit Instructions

1. Pull cover **A** over the back of nozzle to expose the back end.
2. Take handle off nozzle by removing parts **1**, **2**, and **3**.
3. Unscrew part **J** locking nut and remove bolt sleeve **I** and the cartridge **H**.
4. Insert the new cartridge.
5. Re-Install the handle.
6. Replace the sleeve with the open end facing down.
5. Screw the locking nut back into place.
6. Slip the cover back over the nozzle end using a round ended tool similar to a shoe horn.